

BESTEK

BESTEK

WIFI Smart Power Strip

MRJ3013

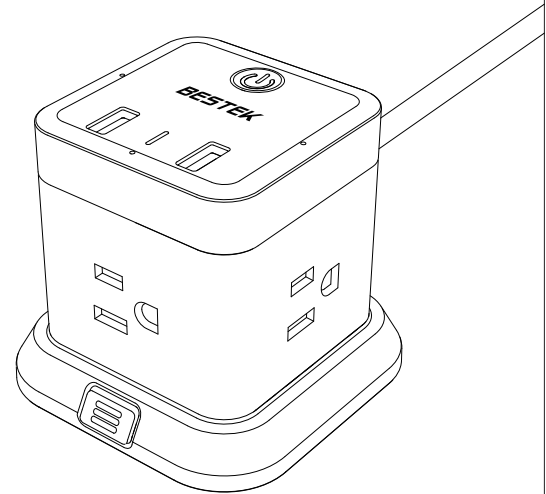

Thank you for choosing this USB Charger from BESTEK store, please read this user manual carefully before using and it will help you use the product safely and easily.

Product description:

This product can work in the United States with AC input 125V/60Hz. And its power cord is UL listed with 1.5 meters long. This power strip can be fixed on the base or taken out as a portable one. It has 3 AC outlets and 2 USB ports, as well as a light touch button, which can control the switch of 3 AC outlets or make the model enter WIFI connection mode, and then your mobile phone can control those outlets after connecting WIFI. AC port with safety door can effectively protect children from electronics. It has the function of automatic recognition when connecting your mobile phone, which can automatically identify your phone type, thus speeding up the charging process of your phone.

Specifications:

AC Input/Output	AC 125V, 60Hz, 13A 1625W Max
USB Output	5V $\overline{=}$ 2.4A (Auto 2.4A Max Per Port)
USB Output Power	12W (Total)
Sockets	3 US Standard AC Outlets + 2 USB Ports
Environmental Temperature	Operating: -10~40 $^{\circ}$ C Store: -20~80 $^{\circ}$ C
Environmental Humidity	Operating From 10% to 90%
	relative humidity(non-condensing)
	Store: From 5% to 95%
cover's Materials	ABS UL94V-0
Cord Length	5 ft
Size	3.40 \times 3.35 \times 3.09 inch
product weight	430 \pm 10g

Features:

- AC Power Expansion:
3 AC outlets with safety doors and 2 USB charging ports can work for your electrical devices at the same time.
- Fast-charging technology:
USB port has automatic recognition function, can automatically identify the type of device and match the corresponding current, which speeds up the charging speed.
- Intelligent control:
The product can be connected to WIFI, and after connecting to WIFI, you can control

1

the switch of 3 AC outlets through mobile phone app.

- Indicator light instruction:
The indicator light on the switch button shows working mode and the small indicator lights indicate the switch of AC outlets.
- User-friendly Design:
Comes with a dock which enables you to place it anywhere, even upside-down underneath your desk or on a wall. You may either use the supplied screws or 3M tapes to install the dock easily to right place you want. Also you may detach the Power Strip out of the dock to use it as a portable power source.

1: You can take the power strip out of the dock by pressing the latches on both sides at the same time. The power strip can be easily and tightly attached to the dock both horizontally and vertically (as Picture 1).

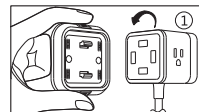

2: Peel off the double-sided tape's liner and stick the double-sided tape onto the bottom of the dock, then peel off the other side's liner, and stick the dock to the right place (as Picture 2).

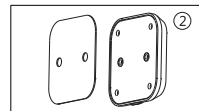

3: Also you may install the dock by screwing it into the place you want (as Picture 3).

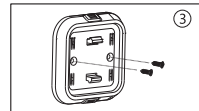

Specifications:

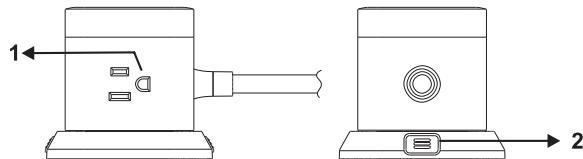

2

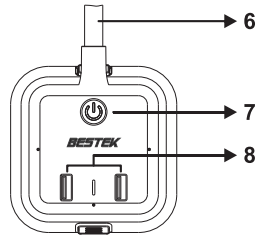
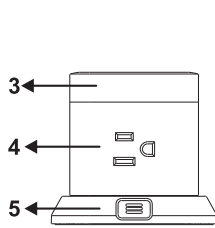

- | | |
|---------------|-------------------------|
| 1: US Outlets | 5: Dock |
| 2: Latch | 6: 5 Feet US Power Cord |
| 3: Cover | 7: Switch Button |
| 4: Housing | 8: USB 5V==2.4A*2 |

How to connect with WIFI:

IOS



Android



Scan the QR-code and download APP

1. Plug the power adapter into wall socket, turn on the lamp, press the switch button for 3 seconds, and the indicator light will flash rapidly. Then, open the app, click "Register"— choose your region — input your phone number — then "Next". Type the identifying code in the first blank and your account password in the second blank. Click "Confirm", then "Allow" to finish registration.
2. Add Device—electrical outlet—confirm indicator rapidly blink—type wifi password —confirm, start to add device. When the progress bar shows 100%, the device has been added. Click "Done" to use (If the steps above don't work, please choose the AP mode to try once again. Reference to the following)

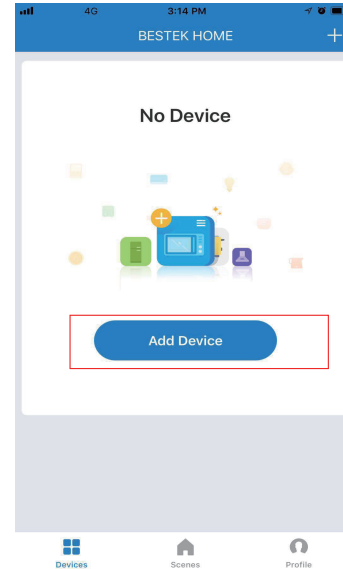

3. Long press the wifi button to connect. Steps are:

“Add Device” — “electrical outlet”—“AP mode” — “confirm indicator slowly blink”- type wifi password —“confirm”, start to add— “Connect Now”. When the interface is for connecting phone to wifi, click “wifi”, then as shown in the screenshot, choose the wifi that matches with “Smartlife-XXXX”—back to bestek home—finish.

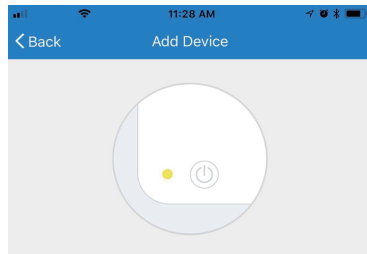

Power on the device and confirm that indicator light slowly blinks

[How to make indicator slowly blink](#)

Confirm indicator slowly blink

Safety precautions:

1. Please check whether device is powered on.
2. Check whether phone is connected to via Wi-Fi.
3. Check Whether device is ready for configuration. To get the device ready before configuration, normally you can manually press on the switch button. Each time when adding device, please reset Wi-Fi to get it ready for configuration and make sure router is working properly.
4. Check routers or related: If router is dual-band, select 2.4GHz network and add device. You also need to enable router's broadcasting function. Set up wireless router: set encryption method as WPA2-PSK and authorization type as AES, or set both as auto. Wireless mode cannot be 11n. To ensure a Strong Wi-Fi signal, please keep device and router within certain distance. Check whether connected devices have reached the Maximum number of router's connection. If so, please try by turning off the Wi-Fi connection of some device. Router's wireless MAC filtering function is enabled. Remove the device from the filter list and make sure that router is not prohibiting device from connection.

Setting Alexa App:

1. Open "Alexa App", click **Home**, then click **Skills**.
(As highlighted below)

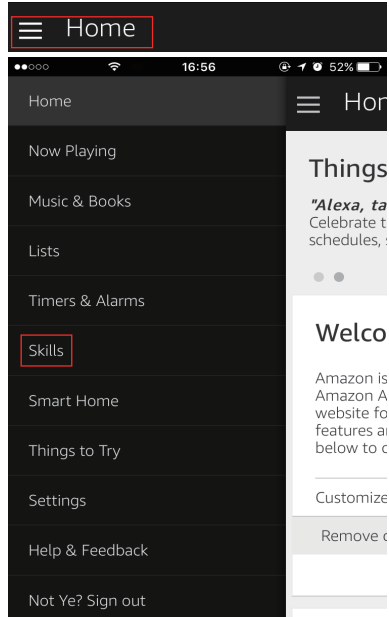

7

2. Type "Smart Life" and click search 
(As highlighted below)

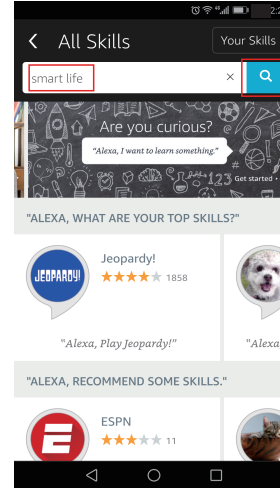

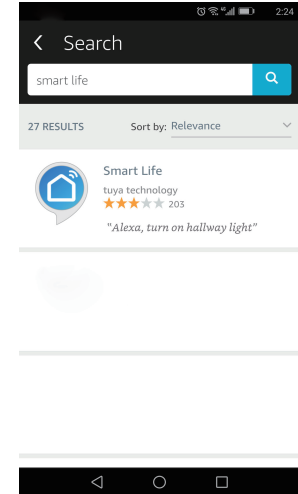

3. Click "Smart Life" and Enter.

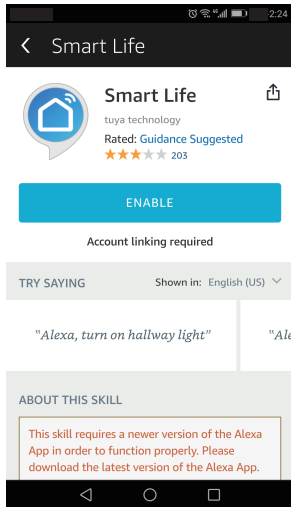

8

4. Click **ENABLE** .



5. Select your country , type your "Smart Life" App account and password which you have registered. (Attention: this is not the account and password of Alexa App). Click **Link Now** .

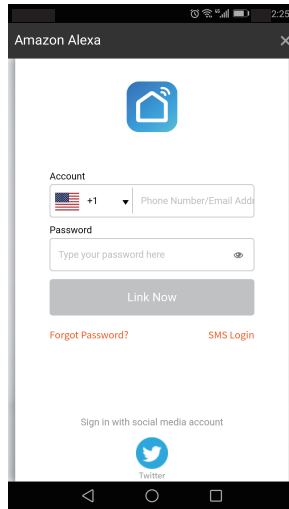

9

6. Setting finished, click close 

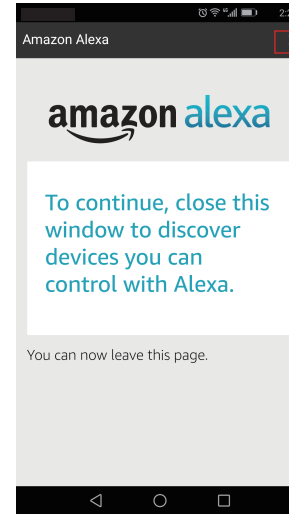

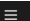
7. Back to Menu, click  Home , and then click **Smart Home** .

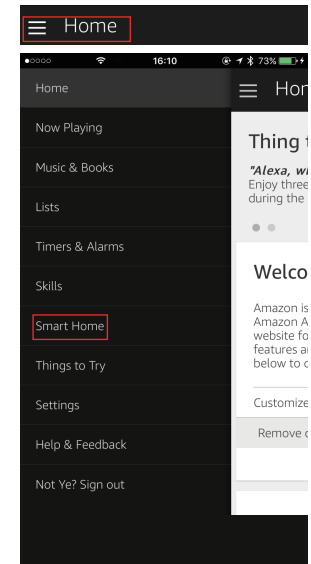

10

8. Scroll down to bottom, click **Discover** to search.

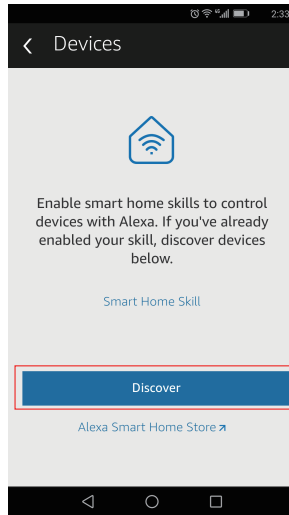
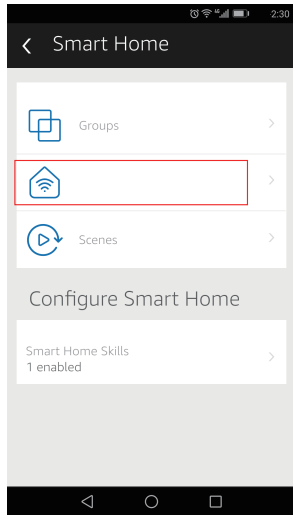

11

9. Search the device. 

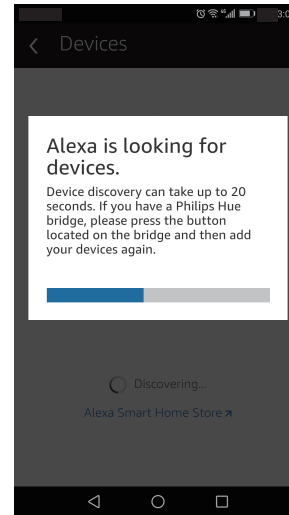

10. Find device.

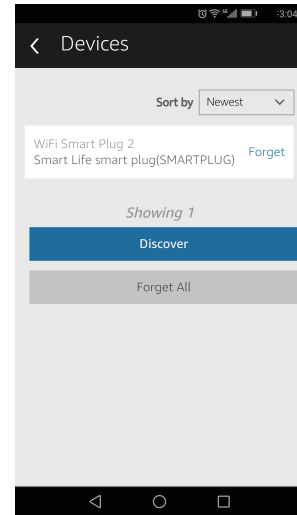

12

11. Move to the top of the screen, click **Create group** to name device.

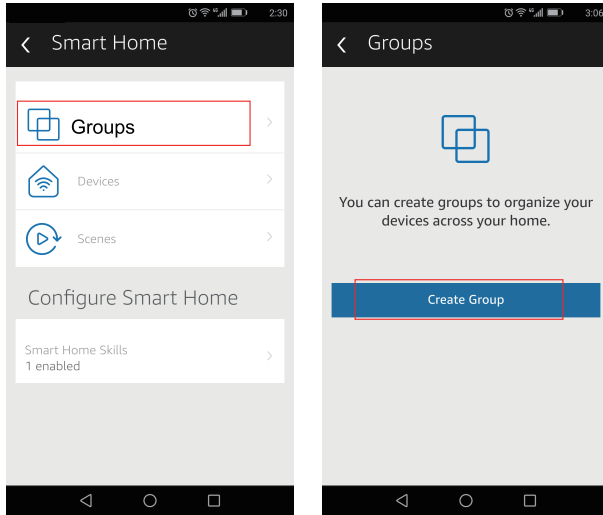

12. Type the name as you like, such as **Living room** . If you have 2 smart devices or more , **WiFi Smart Plug 2** please select one of them, then **Save** .

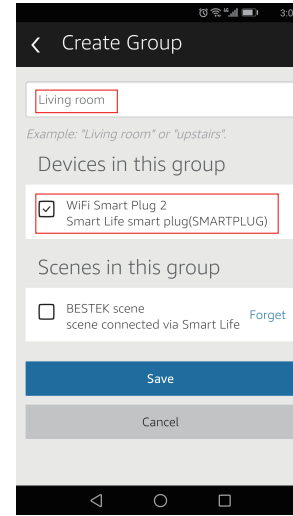

Alexa Skills :

Now, you can use Echo to control different smart plugs. For example, you can say "Alexa, turn on the living room/Alexa, turn on the dining room", then Alexa will turn on different devices separately.

Use Goodle Home to control smart devices

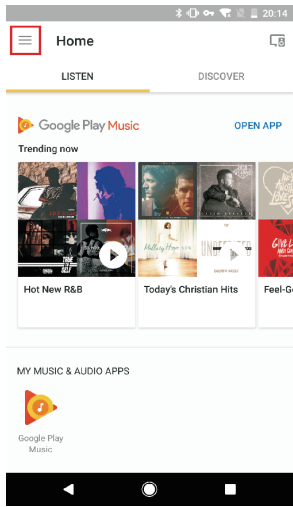

1. Tap "Home Control" in the menu on the Google Home app's home page.

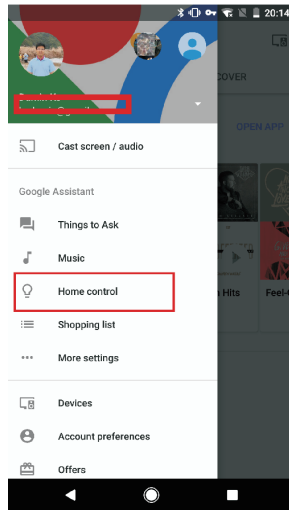

2. Then tap "+".
3. Find "Smart Life" in the list.

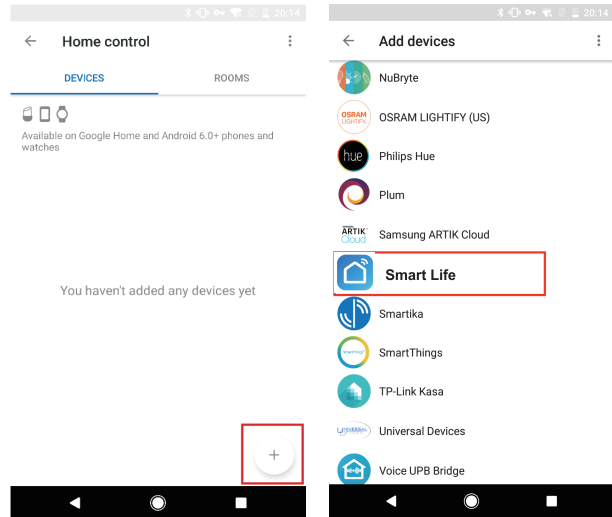

4. In the new window, select your BESTEK HOME account's region, type your BESTEK HOME account and password, then tap "Link Now".
5. After you assign rooms for devices.